

# MINI-ADP®

## ACOUSTIC DOPPLER CURRENT PROFILER

### FEATURES AND OPTIONS

- Compact and light-weight
- Bottom-tracking for underway current surveys
- Directional waves
- Multi-sensor integration

### POWERFUL, ACCURATE and FLEXIBLE

If you are tired of buying multiple instruments for all your monitoring needs, then the SonTek ADP is the solution. SonTek's Mini-ADP is a powerful system that combines current profiling, multi-sensor integration, and wave measurement into a single compact package with a small transducer head.

SonTek's graphical software suite provides quick and easy understanding of your results both in the field and office.

With applications that span underway current surveys, nearshore deployments, benthic studies, or wave monitoring, the Mini-ADP is as robust and resourceful as you need it to be without sacrificing performance.

The Mini-ADP features a unique frequency-based pressure interface for high precision sampling, a small (10 cm) diameter transducer head, and a non-corrosive package that is easy to mount and transport.

So when you are looking for the best performance for your budget, the Mini-ADP is the obvious choice.

*The light-weight and compact Mini-ADP is easy to deploy underwater or mount on a vessel.*

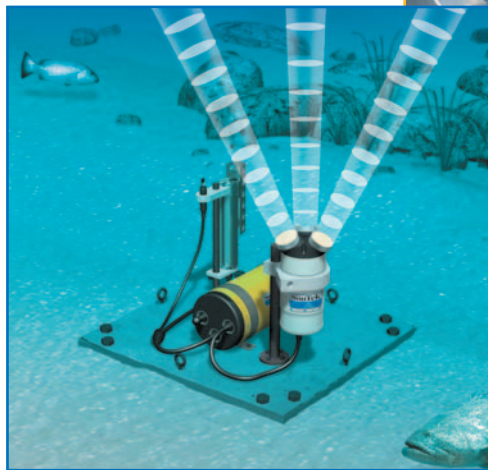

*Integrate additional sensors for a total currents and water quality solution.*

# SPECIFICATIONS

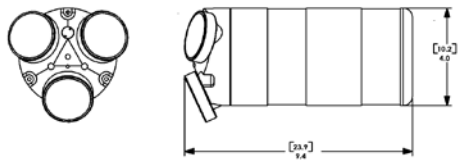

Transducer Head (1.5 MHz)

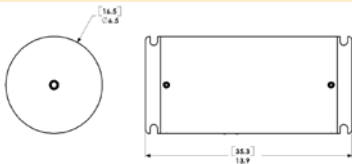

Electronics Housing

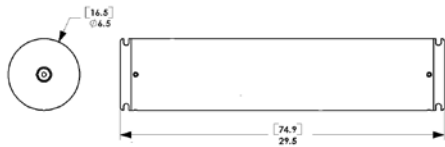

Electronics & Battery Housing

## Mini-ADP®

Frequency	Profiling Range Min - Max	Minimum Cell Size
1.5 MHz Mini	0.5 - 25 m (1.6 - 82 ft)	0.25 m (0.8 ft)
3.0 MHz Mini	0.3 - 6.0 m (1.0 - 20 ft)	0.15 m (0.5 ft)

Nominal range can vary depending on environmental conditions

### Water Velocity

- Range: ±10 m/s
- Resolution: 0.1 cm/s
- Accuracy: ±1% of measured velocity, ±0.5 cm/s
- Up to 100 range cells

### Standard Features

- Compass/2-Axis tilt sensor (up/down)
- Flexible deployment control for reduced duty cycle operation
- Internal recorder
- Temperature sensor
- Battery pack for autonomous operation
- 3 m probe cable (longer cables available)
- 10 m power/communications cable (longer cables are also available)
- Delrin and fiberwound (plastic) housings
- Wet mateable connectors
- Titanium encased transducers with resistant epoxy coating
- Windows (95/98/NT/2000/XP) software for instrument setup, data collection, flow calculation and post-processing

### Sensor Options

- SeaBird MicroCat CT (serial)
- OBS turbidity (analog)
- Internal RPT gage pressure sensor (0.01% accuracy) (frequency)
- Strain gage pressure sensor (0.1% accuracy) (analog)

### GLOBAL HEADQUARTERS SonTek/YSI

9940 Summers Ridge Road  
San Diego, CA 92121  
Tel: (1) 858-546-8327  
Fax: (1) 858-546-8150  
inquiry@sontek.com  
www.sontek.com

SonTek and ADP are registered trademarks of YSI Inc.  
The Mini-ADP is made in the USA. Specifications are subject to change without notice.  
Lit: S09-02-0810



3.0 MHz system

### Optional Features

- Bottom-tracking provides depth and track information during current surveys
- SonWavePro directional wave package
- RS422 output for cable lengths to 1500 m

### Temperature Sensor

- Resolution: ±0.01°C
- Accuracy: ±0.1°C

### Environmental

- Pressure rating: 500 m
- Operating temperature: -5° to 40°C
- Storage temperature: -10° to 50°C

### Power Requirements

- Input power: 12-24 VDC
- Power consumption: 2.0-2.5 W Operating mode
- Total battery capacity (2 packs at 5°C): Alkaline 1200 Wh (20-25 days continuous operation)

Note that external sensors consume additional power.

### Mini-ADP with Integrated Compass/Tilt, Pressure and Temperature Sensors

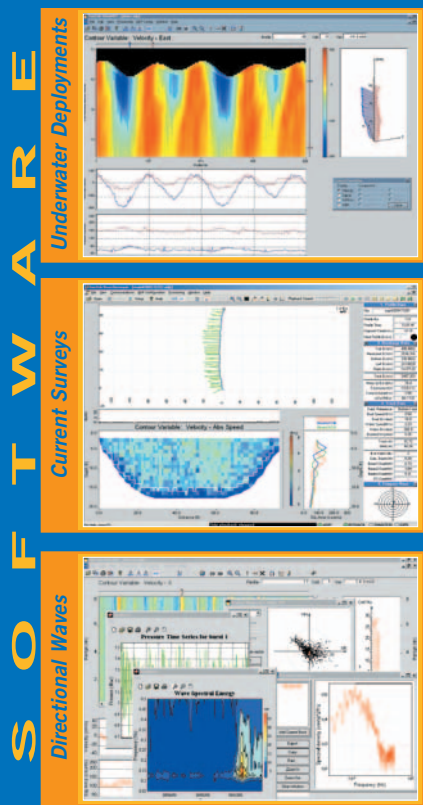
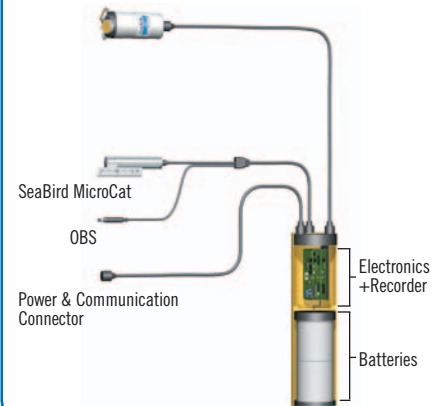

SOFTWARE

Underwater Deployments

Current Surveys

Directional Waves